



Fearon Road, Hastings TN34 2DL

Offers in excess of £325,000



A well presented three bedroom SEMI-DETACHED FAMILY HOME with OFF ROAD PARKING situated in a sought after Blacklands location. It's within walking distance of a local shop, Alexandra Park, local primary and secondary schools and Hastings Town centre where there are additional shopping and leisure facilities along with a mainline railway station which benefits from connections to London stations. One railway station is also close by offering connections to Ashford International and London. The accommodation here is arranged as a BRIGHT LIVING ROOM which is positioned at the front of the property and enjoys a WOOD BURNING STOVE while the MODERN KITCHEN AND DINING ROOM sits at the rear benefiting from access to the garden. The kitchen is fitted to provide ample storage and worktop space along with a handy cupboard for utilities. The first floor houses three bedrooms, two of which are double rooms together with a family bathroom where there is a bath with shower over. Externally, the rear garden offers a decked space perfect for DINING AL-DRESCO followed by a GENEROUS EXPANSE OF LAWN perfect for family life. There is also a LARGE CRAWL SPACE providing plenty of additional storage while to the front of the property there is a DRIVEWAY with space for multiple vehicles.

GROUND FLOOR
382 sq.ft. (35.5 sq.m.) approx.

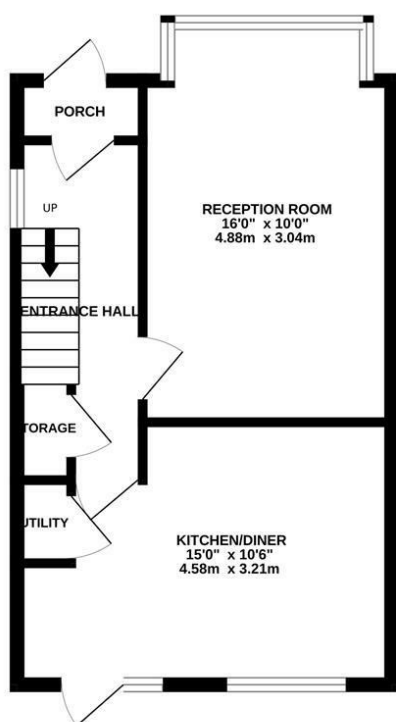

1ST FLOOR
400 sq.ft. (37.2 sq.m.) approx.

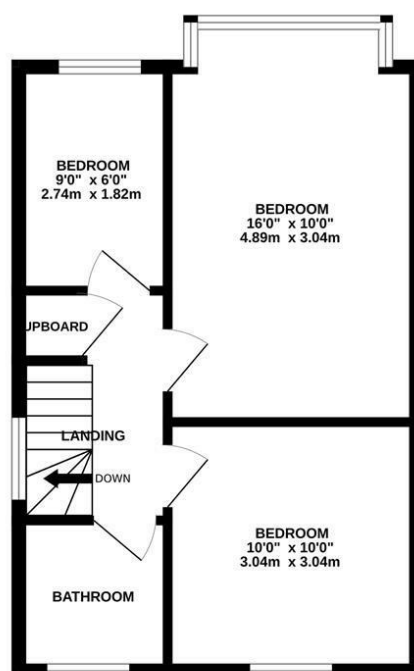

TOTAL FLOOR AREA : 783 sq.ft. (72.7 sq.m.) approx.

Whilst every attempt has been made to ensure the accuracy of the floorplan contained here, measurements of doors, windows, rooms and any other items are approximate and no responsibility is taken for any error, omission or mis-statement. This plan is for illustrative purposes only and should be used as such by any prospective purchaser. The services, systems and appliances shown have not been tested and no guarantee as to their operability or efficiency can be given.

Made with Metropix ©2025

